

ZELUS

GEL Technology Battery

GFT

GFT 12/150

12V, 150Ah/C₁₀

FEATURES

- GFT was designed with solid lead plated and gelled electrolyte technology.
- A deep-cycle lead-acid battery is designed to deliver a maximum capacity and cycles as discharging.
- High temperature stability, mechanical strength and low acid displacement.
- Superior performance with deep discharges.
- Patented safety valve to have accurate pressure operating for long battery life.

APPLICATIONS

- UPS
- Security
- Telecommunication
- Electronic Medical Equipment
- Emergency Lighting



SPECIFICATIONS

Nominal Voltage	12 V
Nominal Capacity	150 Ah @ 10 hour rate F.V.(1.80 V/cell)
Approx. Weight	52.0Kg(114.64lbs.)
Terminals	I3 (M8 Female Thread)
Internal Resistance	≤6mΩ (Fully Charged)
Max. Discharge Current	800 A (5 sec.)
Max. Charge Current	30.0 A
Self Discharge	< 2% per month (25°C)
Operating Temperature Range	-20°C~55°C(-4°F~131°F)
Container Material	Standard: ABS(UL94 HB) GFT12/150 Optional: Flame Retardant ABS(UL94 V-0) GFT12/150FR



C4M20310-2474-E-16

- GB/T 19638.2-2005
- IEC60896-21/22 2004

DIMENSION(mm/inch)

OUTER DIMENSIONS

TERMINAL TYPE

Length

560±2.0 (22.05±0.08)

Width

125±2.0 (4.92±0.08)

Container Height

290±2.0 (11.42±0.08)

Total Height

290±2.0 (11.42±0.08)

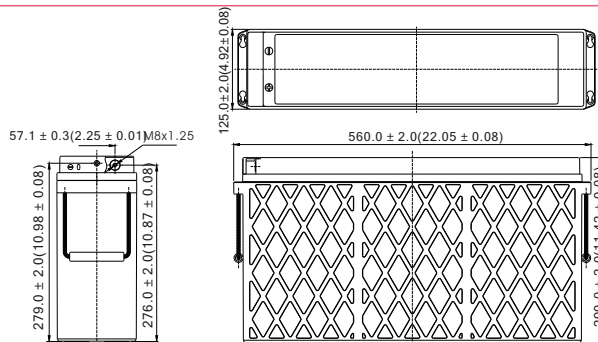

- Terminal I3

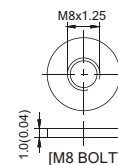

Terminal Hardware Initial Torque: I3(10.0Nm ±5%)

Constant power discharge characteristics at 25 °C/77 °F

Unit: W

F.V. (V/cell) \ Discharge Time	30 Min	1 Hr	3 Hr	5 Hr	10 Hr	20 Hr
1.80V	1788	1042	454.8	317.5	180.0	94.06
1.75V	1819	1073	463.9	322.3	182.3	95.49
1.70V	1837	1096	469.5	325.1	182.7	96.24
1.65V	1853	1109	473.2	326.2	183.1	96.51
1.60V	1859	1120	475.6	327.2	183.1	96.53

Constant current discharge characteristics at 25 °C/77 °F

Unit: A

F.V. (V/cell) \ Discharge Time	30 Min	1 Hr	3 Hr	5 Hr	10 Hr	20 Hr
1.80V	153.3	88.8	38.09	26.54	15.00	7.838
1.75V	156.4	91.5	38.85	26.94	15.15	7.958
1.70V	158.4	93.4	39.32	27.17	15.18	8.020
1.65V	160.3	94.5	39.63	27.26	15.21	8.043
1.60V	161.1	95.5	39.83	27.35	15.21	8.044

All data and artwork shall be changed without prior notice, BB reserves the right to explain and update the information contained hereinto

For operation, please refer to the instruction from technical manual.

Trial A/5 REV. Jan. 2022

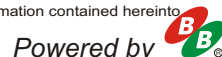

B.B. Tech(Changsha) CO.,LTD