



VRLA Rechargeable Battery

BPL12-12 (BPL12-12FR)



FEATURES

- Maintenance free(no water topping-up required).
- No free acid(Non-spillable battery).
- Low self-discharge rate, lower than 3% capacity loss per month.
- Can be used in any orientation(excluding used inverted).

APPLICATION

- UPS
- Laboratory Equipment
- Toy-Cars
- Power Packs
- Fishing Lights



SPECIFICATIONS

Nominal Voltage	12 V
Nominal Capacity	12.0Ah @ 20 hour rate F.V.(1.75V/cell)
Approx. Weight	4.1Kg(9.04lbs.)
Terminals	T2 (Faston Tab 250) T1 is optional
Internal Resistance	≤16m Ω (Fully Charged)
Max. Discharge Current	180 A (5 sec.)
Max. Charge Current	3.6 A
Operating Temperature Range	Charge : 0°C~40°C(32°F~104°F) Discharge : -20°C~50°C(-4°F~122°F) Storage. : -20°C~40°C(-4°F~104°F)
Container Material	ABS(UL94-HB, UL94-V0 is optional)

ISO 9001	
ISO14001	
UL	
CE	
<ul style="list-style-type: none"> ● IEC61056 ● JIS C 8702 ● GB/T 19639 	

DIMENSION(mm/inch)

OUTER DIMENSIONS

TERMINAL TYPE

Length

151±1.5 (5.94±0.06)

Width

98±1.5 (3.86±0.06)

Container Height

94±1.5 (3.70±0.06)

Total Height

98±2.0 (3.86±0.08)

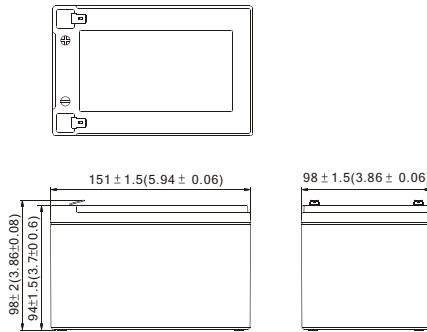

Terminal T1

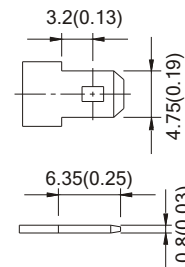

Terminal T2

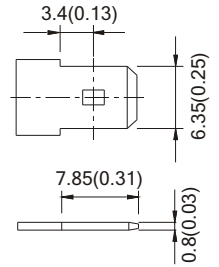

Constant power discharge characteristics at 25 °C/77 °F

Unit: W

Discharge Time F.V. (V/cell)	5 Min	10 Min	15 Min	30 Min	1 Hr	3 Hr	5 Hr	10 Hr	20 Hr
1.80V	391.0	293.8	238.1	143.2	83.0	35.0	24.10	13.48	7.05
1.75V	452.0	318.3	249.0	148.6	85.5	35.7	24.50	13.68	7.20
1.70V	480.0	329.8	256.7	152.0	87.0	36.0	24.60	13.75	7.23
1.65V	502.0	337.7	262.6	154.2	88.0	36.3	24.70	13.80	7.25
1.60V	518.0	344.4	267.8	155.7	88.9	36.5	24.80	13.80	7.25

Constant current discharge characteristics at 25 °C/77 °F

Unit: A

Discharge Time F.V. (V/cell)	5 Min	10 Min	15 Min	30 Min	1 Hr	3 Hr	5 Hr	10 Hr	20 Hr
1.80V	35.23	25.86	20.70	12.14	6.97	2.92	2.008	1.123	0.588
1.75V	41.47	28.02	21.65	12.59	7.18	2.98	2.042	1.140	0.600
1.70V	44.04	29.03	22.32	12.88	7.31	3.00	2.050	1.146	0.603
1.65V	46.06	29.73	22.83	13.07	7.39	3.03	2.058	1.150	0.604
1.60V	47.52	30.32	23.29	13.19	7.47	3.04	2.067	1.150	0.604

All data shall be changed without prior notice, BB reserves the right to explain and update the information contained hereinto.